

MAXI SKY 2 ADVANCED CEILING LIFT SYSTEM



ArjoHuntleigh proudly introduces *Maxi Sky 2*, an innovative, technically advanced and intuitive ceiling lift system.

Maxi Sky 2 is easy to operate, utilizing a handset control to perform patient transfers with minimal effort, causing a reduction in manual handling. The ceiling lift system is optimized to suit the needs of the specific

working environment and it is quick and easy to install. The tracks are available in a choice of lengths and curvatures, and the versatile system includes a variety of accessories and configurations to enable a customized fit to each and every situation. This system offers a wide portfolio of spreader bars which are compatible with either clip or loop slings and a full range of slings to suit all needs.



...with people in mind

THE DYNAMIC PATIENT HANDLING SOLUTION

This innovative ceiling lift system offers maximum flexibility, for a fixed patient transfer system to suit all types of healthcare facility needs.

Maxi Sky 2 provides quick and effective solutions for highrisk patient handling tasks in both acute and long term care environments. A handset with integrated Powered Dynamic Patient System (PDPS) controls enables a caregiver to perform transfers without stress or strain, and minimizes manual lifting. An LCD display on the cassette communicates valuable usage information to the caregiver.

The Maxi Sky 2 system has never looked better – thanks to the new embedded KWIKtrack™ – which provides aesthetically pleasing solutions utilizing both straight and curved track

configurations. The track sections fit together easily by using a unique pin-locking system and the tight radius of the curved sections enable layouts to use space more efficiently. Special features such as the Enhanced Charging System (ECS), ensures that the lift is always ready for use.

Maxi Sky 2 offers a full-range of spreader bars which are compatible with either clip or loop slings to satisfy any patient handling requirement.

The new Quick-Connect system provides an easy and safe means to change spreader bars. New loop spreader bars with spring-loaded latch technology will greatly increase the safety and efficiency of care. The system is also available with a variety of stretcher frames and a supportive, easy-fit walking jacket.

KEY FEATURES AND BENEFITS



Intuitive user interface with easy access to usage monitoring information and user friendly technical menus.

- LCD interface gives instant and clear feedback on the state of the lift

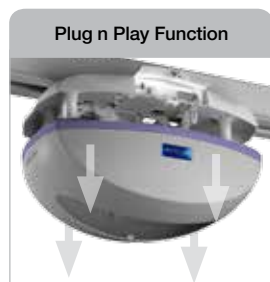

- Plug n' play ready: ECS, PDPS, IR
- Possible to upgrade software in field



- New info button on the handset gives the carer quick and easy access to basic usage monitoring data information

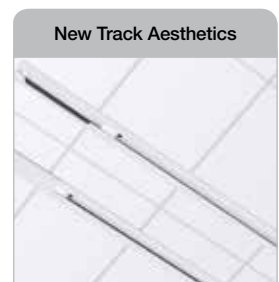

Configurations to enable custom fit, nice invisible and aesthetic design options:

- Embedded tracks
- Increased lifting height
- Mirror effect
- Wall mounted tracks



- Easy to use, intuitive concept
- No tools required to change spreader bar

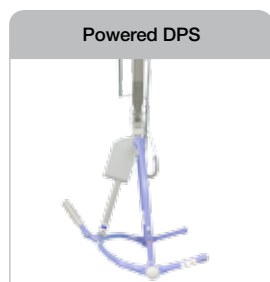

The Powered DPS (Dynamic Positioning System) enables the unique ability to effortlessly change the patient's position between upright and reclined.

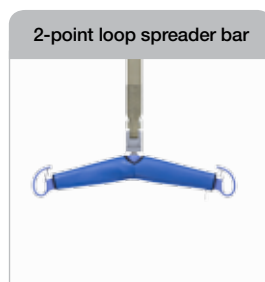

- Compatible with Quick Connect System

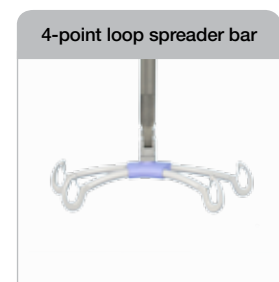

- Increased comfort for larger and medium sized patients.

OVERALL DIMENSIONS

Cassette and Tracks

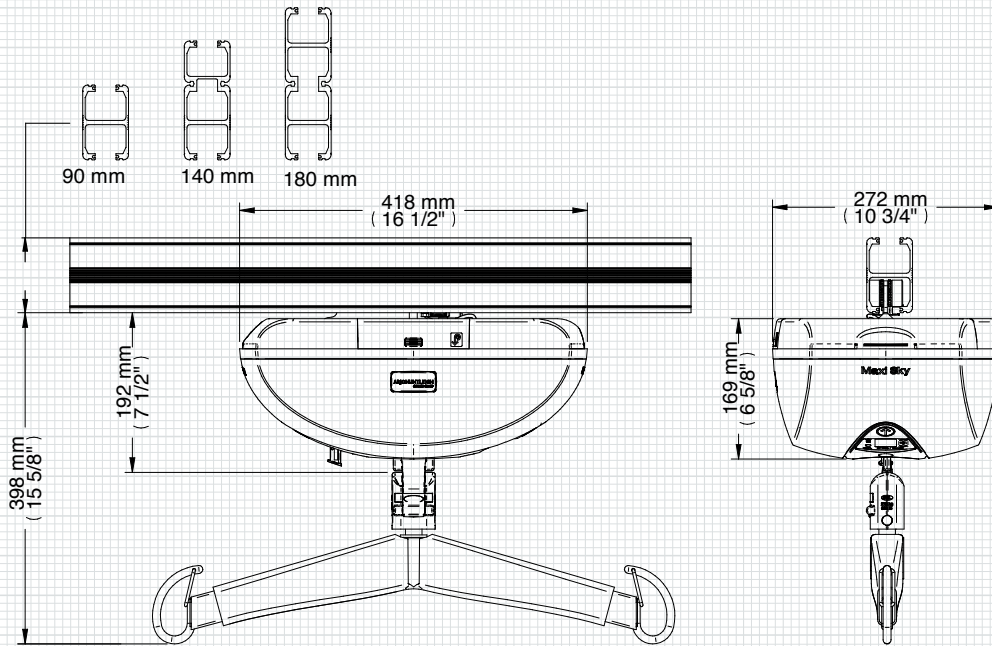

Scale

Spreader Bars

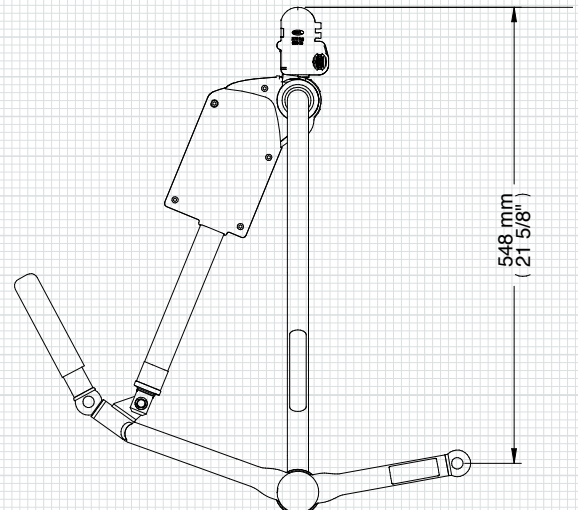
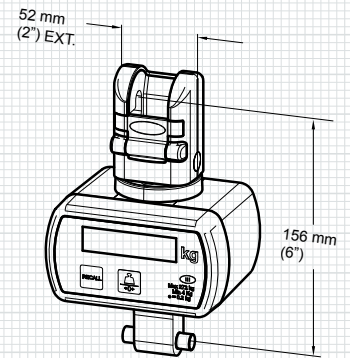
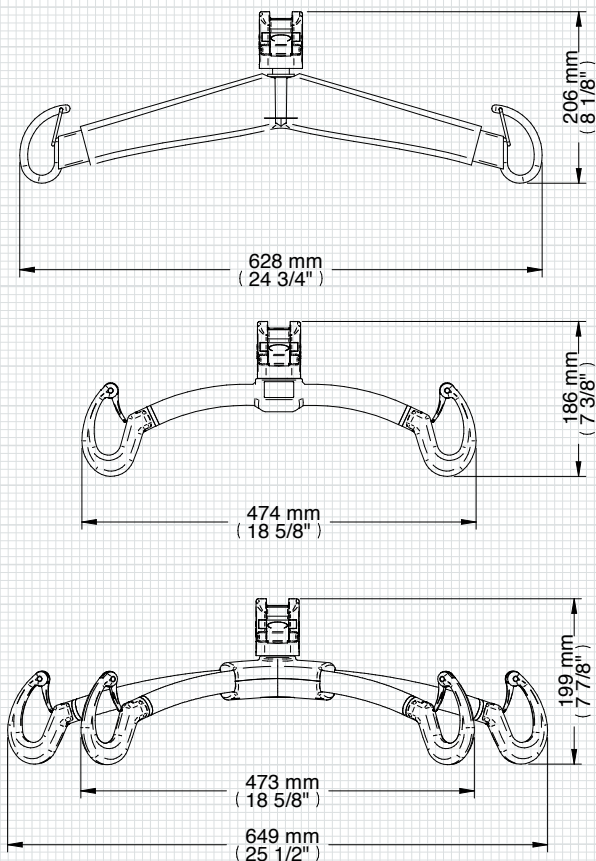

Technical specifications

GENERAL

Weight, complete (Four-function model)	12.3 kg (27 lbs)
Weight, complete (Two-function model)	11.6 kg (25 lbs)
Lifting capacity	120 kg (265 lbs) 200 kg (440 lbs) 272 kg (600 lbs)
Strap length	2500 mm (98.4")
Lifting speed	6.0 cm/s (2.4"/s) without load 3.5 cm/s (1.4"/s) at 200 kg (440 lbs) 2.5 cm/s (1"/s) at 272 kg (600 lbs)
Maximum stroke (from ceiling)	2300 mm (90.6")
Horizontal displacement speeds	10, 15 and 20 cm/s (4", 6" and 8"/s)

ELECTRICAL

Duty cycle	Up/Down Motor: Max 10%. 1 minute continuously Left/Right Motor: Max 20%, 5 minutes continuously Sit/Reclined Motor: Max 10%, 2 minutes continuously
Horizontal axis motor	24 VDC, 62 watts
Vertical axis motor	24 VDC, 110 watts
Rating	24 VDC, 15 A max.
Noise level for either raising or lowering	61 dBA max. (with or without load)
Medical equipment	Type BF protection against electrical shock in accordance with IEC 60601-1
Battery type	Sealed rechargeable valve regulated lead acid battery
Degree of protection - Hand control	IPX7
Degree of protection - Lift	IP24
Lift - protection class - shock prevention	Internally powered equipment
Battery Charger input	100-240 VAC, 50-60 Hz
Battery Charger output	28.1 VDC, 1 A max
Battery Charger safety protection	Class 2, double insulated

OPERATION AND STORAGE CONDITION

Normal Operation	Ambient temperature range: 10°C to 30°C (50°F to 86°F) Relative humidity range: 10% to 70% Atmospheric pressure range: 700 hPa to 1060 hPa
Storage	Ambient temperature range: -40°C to 70°C (14°F to 158°F) Relative humidity range: 10% to 70% Atmospheric pressure range: 500 hPa to 1060 hPa

APPROVALS AND LIST OF STANDARDS

CSA No 601.1, UL No 2601-1 certifications CE marked / ISO 10535, TÜV

ArjoHuntleigh UK – Head Office
ArjoHuntleigh House,
Houghton Hall Business Park,
Houghton Regis, Bedfordshire,
LU5 5XF, United Kingdom
Sales Phone: +44 (0) 1582 745700
Sales Fax: +44 (0) 1582 745745
Rental 24hr Helpline
Lo-call Phone: +44 (0) 8457 342000
Rental Fax: +44 (0) 1582 745843
Email: sales.admin@ArjoHuntleigh.com
www.ArjoHuntleigh.co.uk

ArjoHuntleigh UK
Service and Technical Centre
St Catherine Street,
Gloucester, GL1 2SL,
United Kingdom
Phone: +44 (0) 8456 114114
Service Fax: +44 (0) 1452 525207
Email: ukservice@ArjoHuntleigh.com

ArjoHuntleigh (Ireland)
EA House,
Damastown Industrial Park,
Mulhuddart, Dublin 15,
Republic of Ireland
Phone: 01 809 8960
Fax: 01 809 8971
Email: dublin@ArjoHuntleigh.ie
www.ArjoHuntleigh.ie

ArjoHuntleigh (Ireland)
19 Herson Road,
Sydenham Business Park,
Belfast, BT3 9LE,
Northern Ireland
Phone: 028 9050 2000
Fax: 028 9050 2001
Email: belfast@ArjoHuntleigh.com
www.ArjoHuntleigh.ie